

Descalcificar o aparelho

Duração aproximada 40 min.

Material necessário:
 pastilha anticalcário de 2 fases
 (Art. 61848)



⚠ Este manual breve não substitui o “Manual de instruções WE8”. Primeiro, leia e respeite as instruções de segurança e advertências para evitar perigos.

Pré-requisito:



“Descalcificação”

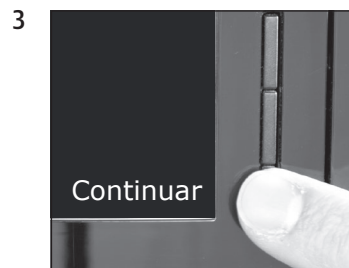

“Esvaziar bandeja de recolha de água”

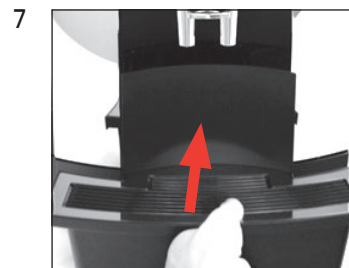
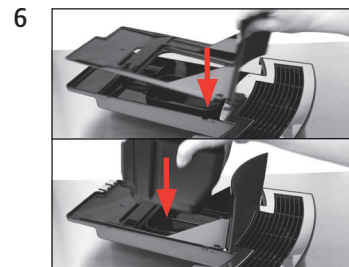
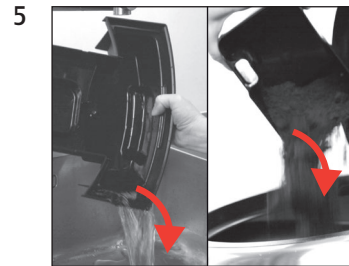
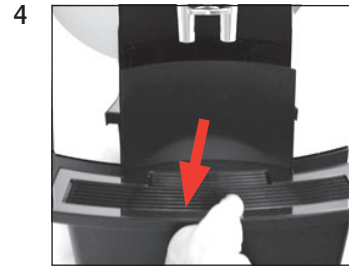

“Colocar no tanque”

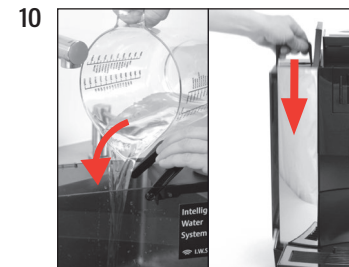
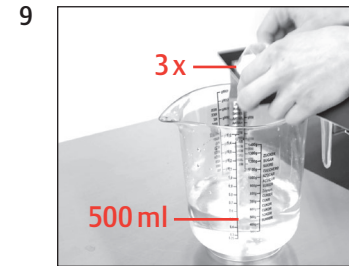
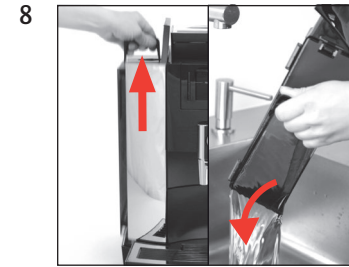

“Aparelho descalcificando”
 “Esvaziar bandeja de recolha de água”

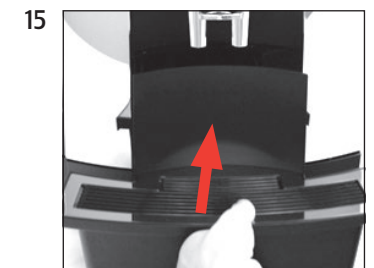
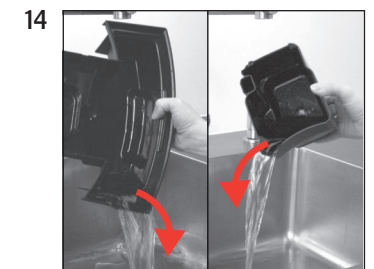
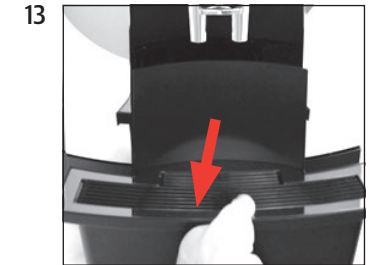

“Encher o depósito de água”



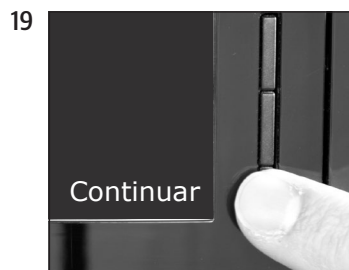
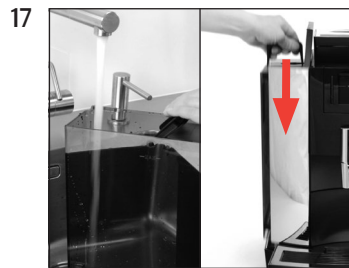
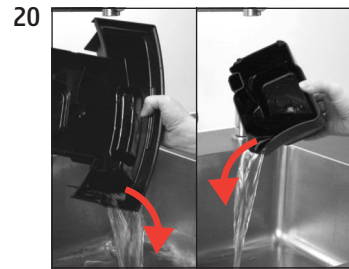
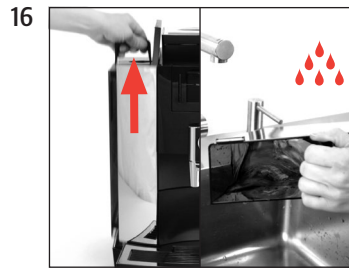

“Aparelho descalcificando”
“Aparelho lavando”
“Esvaziar bandeja de recolha
de água”